

ORDNANCE SURVEY MAP - 1:1250

ELEVATIONS - 1:100

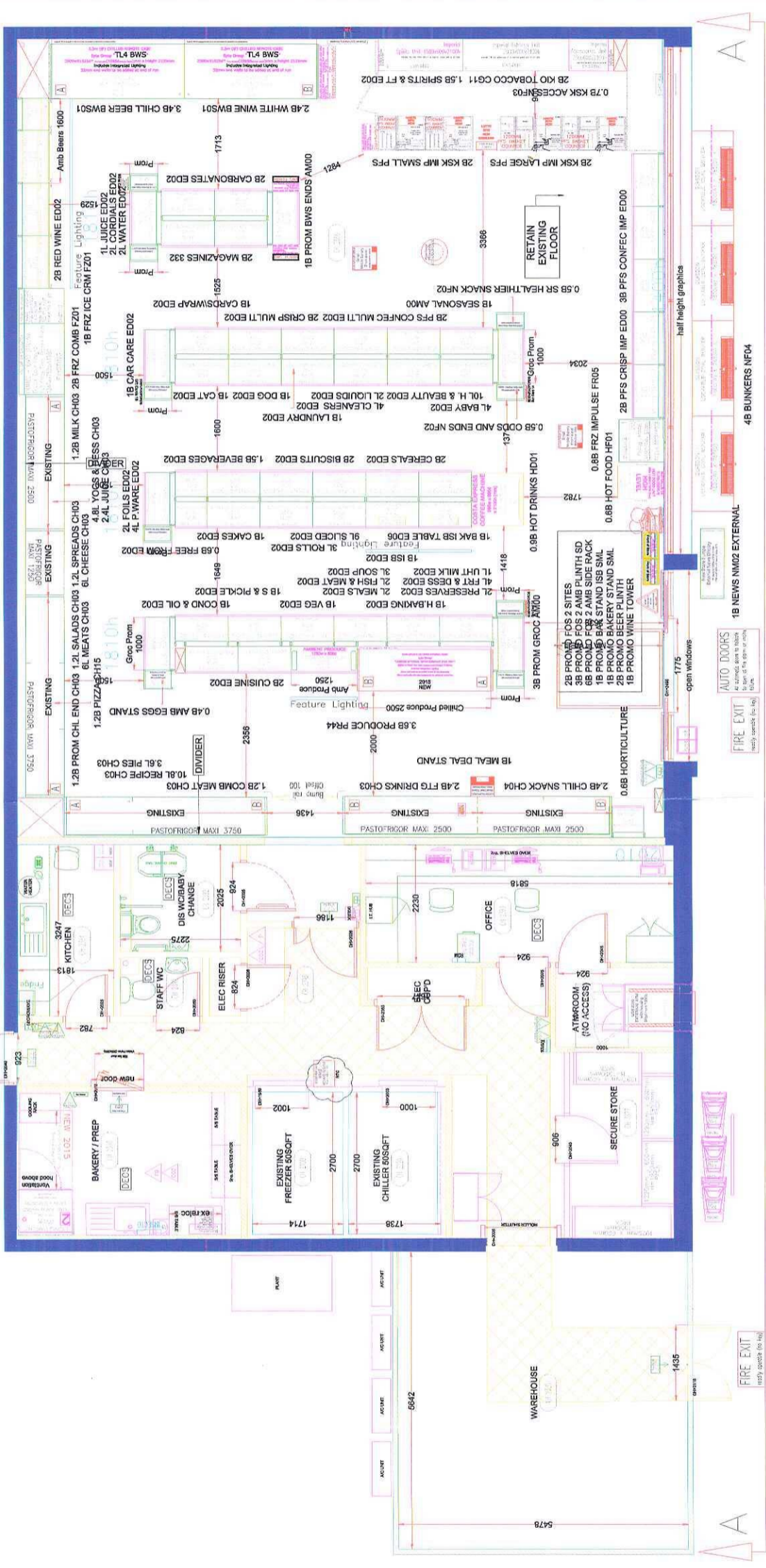

CUSTOMER ENTRANCE

SHOP FLOOR - 1:50

| Description of Amends | FEASIBILITY CAD | SECOND REVIEW CAD | LOCKED CAD | 16.06.2015/Patrol Pounds Hill - P3F5M0/AJ | Standard Notes | CDM Regulations 2015 | Exceptions | Additional Equipment | Drawing Information |
|--|---|--|---|---|---|---|--|--|---------------------|
| 09.06.2015/Patrol Pounds Hill - P3F1M0/AJ FEASIBILITY CAD 12.07.2015/Patrol Pounds Hill - P3F2M0/KF(ACG) FIRST REVIEW CAD 1. Oven omitted. 2. New lockers. 3. Fixture locations amended. 4. Existing cabinets retained. 5. New cabinet. 6. New cabinet. 7. New cabinet. 8. ISB refitted. 9. Fixtures amended. 10. Note amended. | 16.06.2015/Patrol Pounds Hill - P3F3M0/KF(ACG) LOCKED CAD 1. Case comments amended. 2. Case comments amended. 3. Litter station allocated. 4. Plinth added. 5. Plinth omitted. 6. Plinth added. 7. Community screen added. 8. Existing backline retained. 04.08.2015/Patrol Pounds Hill - P3F4M0/AJ THIRD REVIEW CAD FSS plinths and flowers swapped Spork added Boxing out at till added | 22.08.2015/Patrol Pounds Hill - P3F5M1/RSFW INITIAL CATEGORY SPACE ALLOCATION ADDED. 28.08.2015/Patrol Pounds Hill - P3F5M2/SFW Healthy Snacking SR added opposite the kiosk. | V6B - All building specifications are based on the specifications for the building type. For all work, the contractor shall ensure that the work is carried out in accordance with the specifications. V6C - The contractor shall ensure that the work is carried out in accordance with the specifications. V6D - The contractor shall ensure that the work is carried out in accordance with the specifications. | Standard Notes All work shall be carried out in accordance with the specifications. Standard Notes All work shall be carried out in accordance with the specifications. Standard Notes All work shall be carried out in accordance with the specifications. | CDM Regulations 2015 The contractor shall ensure that the work is carried out in accordance with the specifications. CDM Regulations 2015 The contractor shall ensure that the work is carried out in accordance with the specifications. | Exceptions Any areas of this proposal that are not included here should be discussed with the client. Exceptions Any areas of this proposal that are not included here should be discussed with the client. | Additional Equipment VND, Magazines, Cards, Impulse Contact, Impulse CSN, Pizza Step, Bakery, BWS Prom, Eden Bakery Stand n/a, Grocery Prom, Electrical Shelving n/a, Roll Cages BOH, Promo Plinths, top box | Drawing Information Existing: 3594 Sq. Ft., 1891 Sq. Ft., 1970 Sq. Ft. Proposed: 3594 Sq. Ft., 1891 Sq. Ft., 1974 Sq. Ft. | |

SURVEY OVERLAIN

POUND HILL (PFS), CRAWLEY
 8 Pound Hill Parade
 Crawley
 RH10 7EA
 Store Phone No: 01293 513310
 Format: PFS
 Hub Number: 9845
 Drawing Information
 Brief Description Of Works:
 Proposed Future Layout
 Drawn By: AJ
 Scale: 1:50
 Job Originated By:
 Refreshment Programme 2015 Moscow
 Drawing No: xx/xx/xx
 Macro Rev: F5
 PFS Pounds Hill-P3
 The Co-operative Group
 15/01/2018
 A1