

IMPORTANT:- Licensable activities can take place anywhere within the red line. The position of loose furniture and equipment is shown for diagrammatic purposes only. Firefighting equipment is indicated but may be moved subject to the fire risk assessment carried out under the Regulatory Reform (Fire Safety) Order 2005 or by agreement with the fire officer.

LEGEND	
TYPE	SYMBOL
FIRE ALARM PANEL	FAP
3 HOUR MAINTAINED EXIT SIGN	EXIT
BREAK GLASS CALL POINT	CP
HEAT DETECTOR/SOUNDER	DH
SMOKE DETECTOR/SOUNDER	DS
3 HOUR NON-MAINTAINED EMERGENCY LIGHT	E
FIRE BLANKET	FB
DRY POWDER EXTINGUISHER	DP
9 LITRE CO2 EXTINGUISHER	CO2
DOOR TO BE LOCKED BACK DURING OPERATING HOURS	E1
DOOR TO BE FITTED WITH PUSH BAR, PANIC BOLT & LABELLED ACCORDINGLY	E1,E2,E5
DOORS THROUGHOUT WILL BE MINIMUM 1 HR FR (FD30) FITTED WITH A SELF-CLOSING DEVICE.	FD30

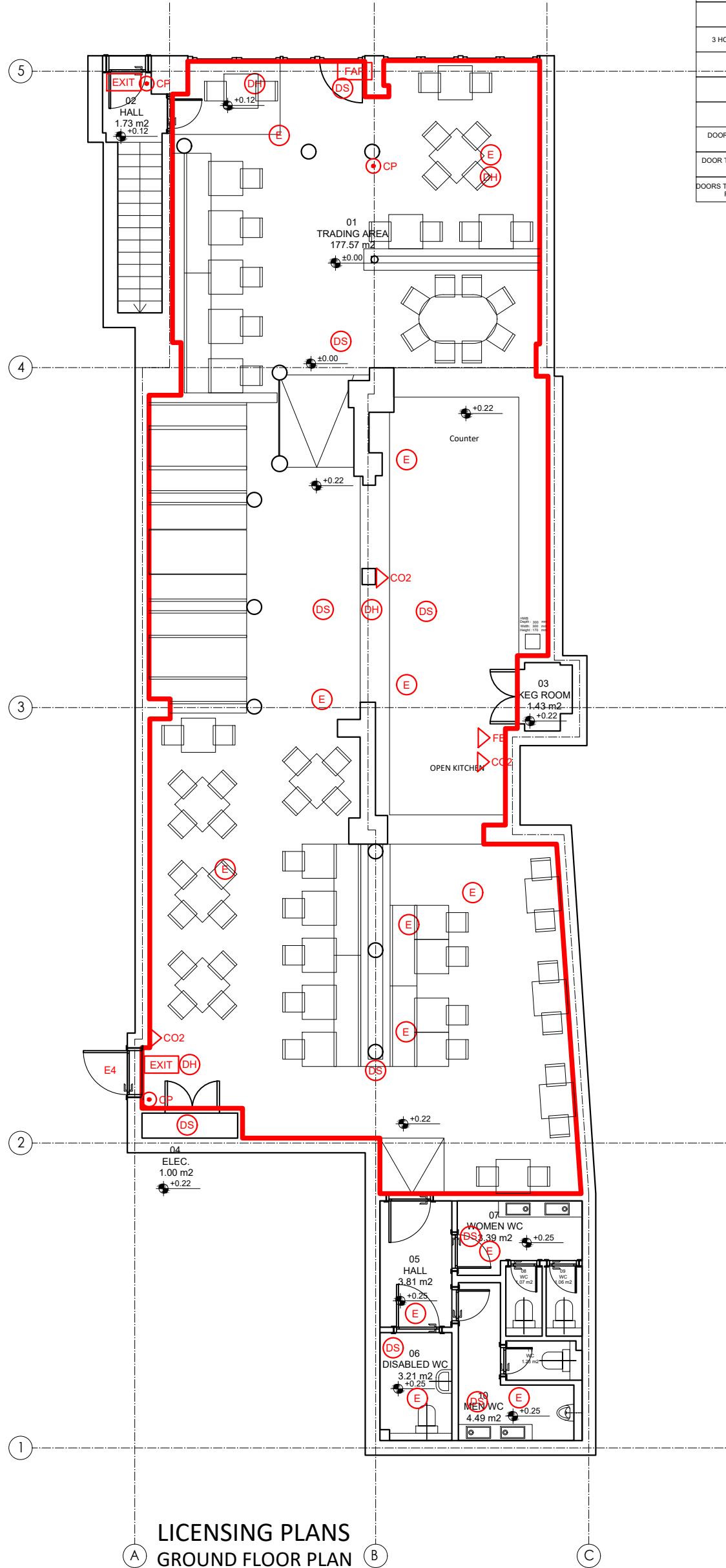

LICENSING PLANS
GROUND FLOOR PLAN

Drawing No:
105

Drawn by:
AKART DESIGN

Project:
TURKUAZ
CRAWLEY

Revision Notes:

Rev: Date: Notes:

Scale @A1:
1/50

Client:
TURKUAZ

Drawing Title:
PLAN

Date:
22.09.2021



info@akart.co.uk
576A Lordship Lane
London N22 5BY
+44 7456159367