

**KEY**

-  EMERGENCY LIGHTING
-  PROTECTED CAMERA
-  NEW LCD CEILING MONITOR
-  EXISTING CEILING MONITOR
-  POWDER EXTINGUISHER
-  CO2 EXTINGUISHER
-  SMOKE DETECTOR

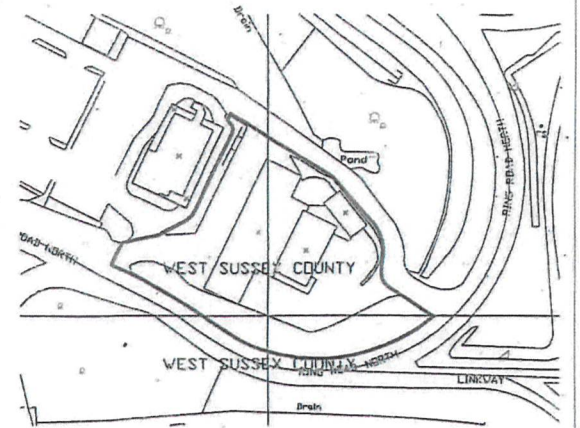

**SITE OS LOCATION MAP 1:1250**

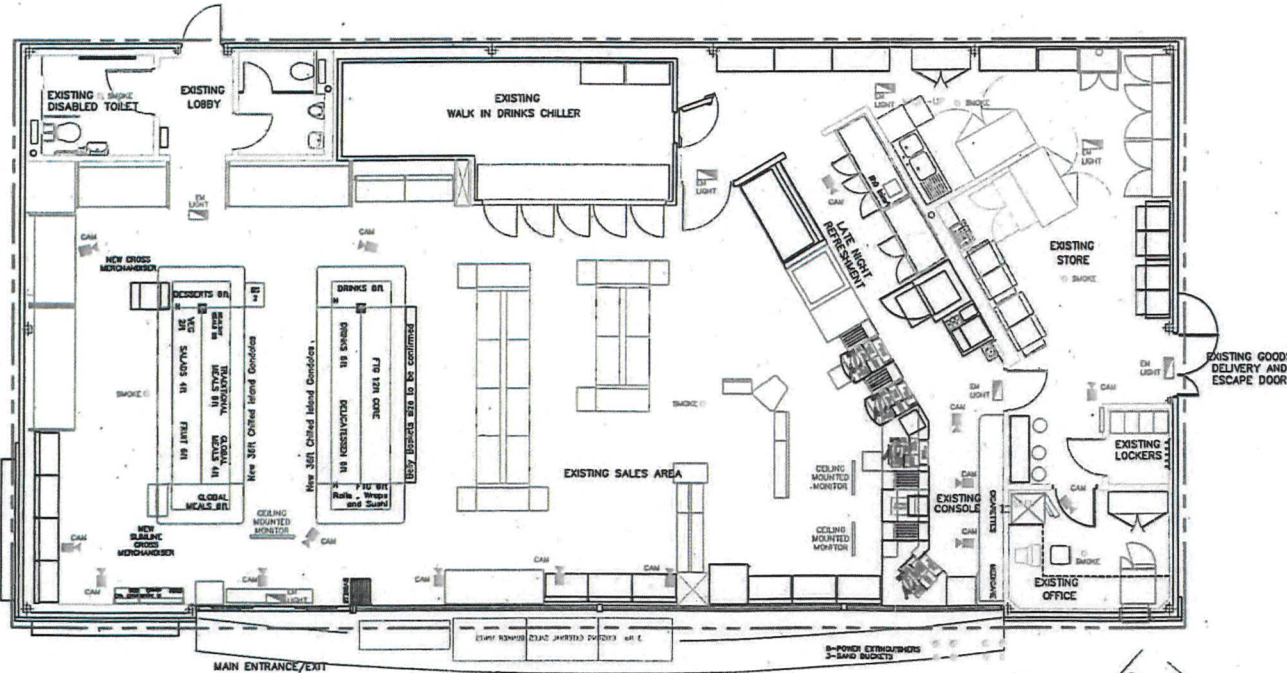

ENTIRE STORE TO BE LICENSED FOR THE SALE OF ALCOHOL AND THE PROVISION OF LATE NIGHT REFRESHMENT

Rev	Date	Revision

**REVISION APPROVAL**

OWNER	NAME & SIGNATURE	DATE
RETAIL A & D MGR		



BP OIL UK LTD  
Asset Development  
Witan Gate House,  
500/600 Witan gate,  
Central Milton Keynes, UK  
01908 853000  
01908 853628

**GATWICK SOUTH SF CONNECT**  
RING ROAD NORTH - A23  
LONDON GATWICK AIRPORT  
GATWICK, WEST SUSSEX RH6 0NN

DRAWN: M.MERAU  
DATE: JUL 2009

**NEW SHOP LAYOUT**

DESIGN APPROVED: M.MERAU  
DATE:  

FILE:	DRAWING No	REV
14377-79	14377-79	-

SCALE: 1:100@A3  
DIMENSIONS IN: MM

COPYRIGHT OF BP OIL UK LTD. ILLEGAL USE IS PROHIBITED. REPRODUCTIONS ONLY WITH PERMISSION OF BP. BP OIL UK LTD, ASSET DEVELOPMENT, 500/600 WITAN GATE WEST, MILTON KEYNES, MK9 1ES

**RECEIVED**  
23 JUL 2009  
ENVIRONMENT AND HOUSING DIRECTORATE