

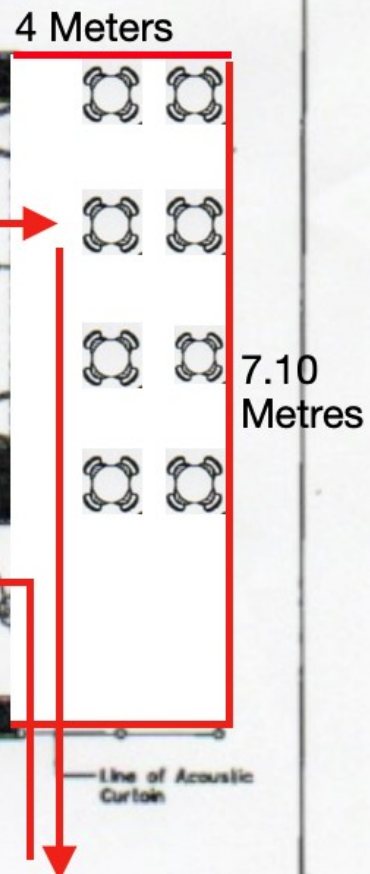

NOTE 1
 Higher density plasterboard for walls and ceiling to reduce airborne sound transmission.
 Acoustic plasterboard to be acoustically attenuative to standard plasterboard. It complies fully with BS EN12320 and is categorised as Type A, B.
 Thermal Conductivity 1.0-0.21W/mK
 Fire Rating Class 0'

Hatching indicates region where all walls and ceiling are to be treated with acoustic plasterboard. (See Note 1)

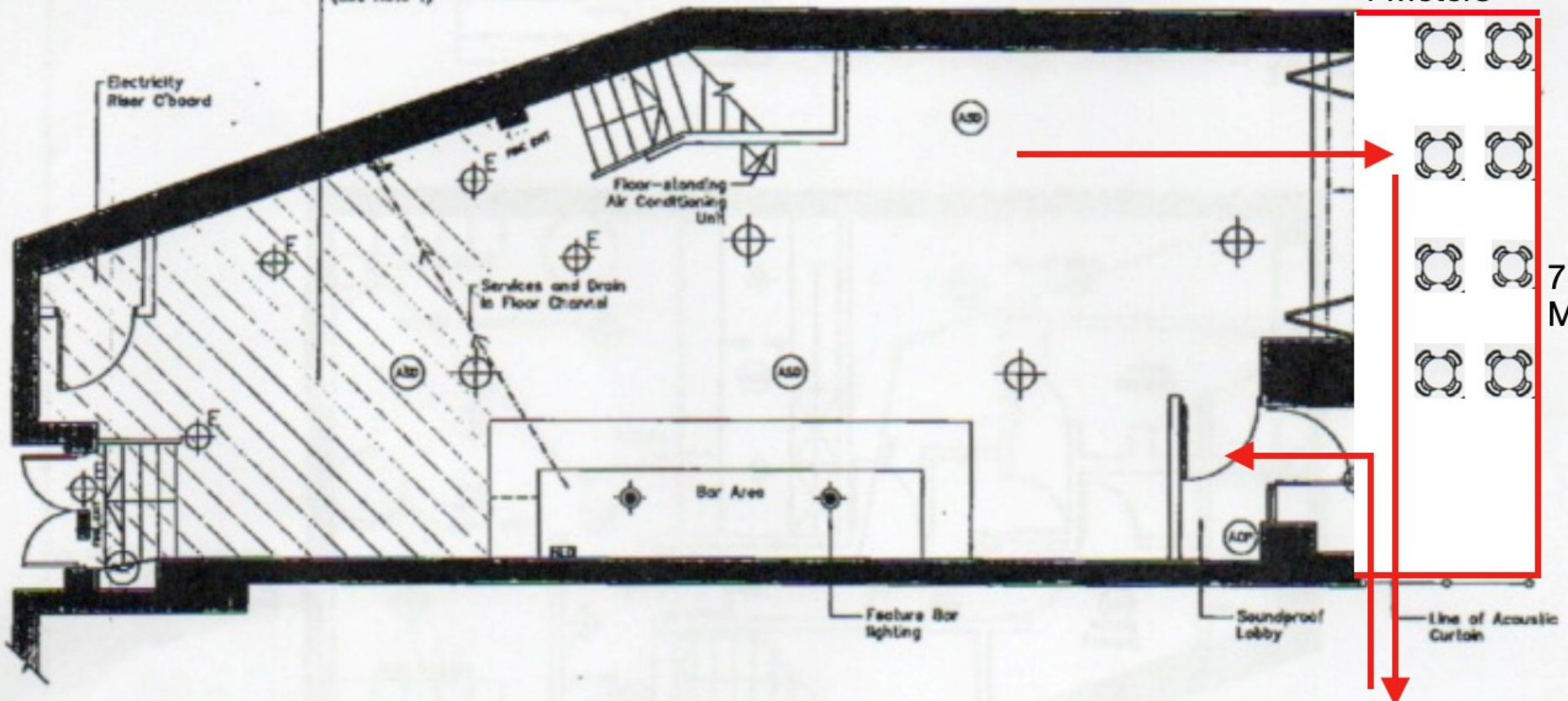

- EMERGENCY LIGHTING
- ILLUMINATED FIRE EXIT SIGN
- ILLUMINATED DIRECTIONAL FIRE EXIT SIGN
- AUTOMATIC SMOKE DETECTOR
- ALARM CALL POINT
- HOSE LIGHTING DEVICE

NOTES
 Music System to be linked to fire alarm system to go off automatically when fire alarm is activated.

Tread Distance from top of Stairs to final call = 13.254M

RD W ARCHITECTS
 RWD ARCHITECTS LIMITED
 OLIVE HOUSE
 11 EAST PARK, GRIMLEY
 WEST SUSSEX, BN15 6AH
 TEL: 01293 864300
 FAX: 01293 864289
 EMAIL: info@rdwarchitects.co.uk
 WEB: www.rdwarchitects.co.uk

BUREAU OF APPROVED MANAGERS
 REGISTERED DESIGNER

PROJECT
 Facade Replacement
 Angelique Bar, 93 High St,
 Crawley, West Sussex, RH10 1BA

Ground Floor Plan
 (As Proposed)

DATE	12.11.2012	SCALE	1:50 @ A3
DRAWN	TGB	CHECKED	
PROJECT	4048-110		