

ORDNANCE SURVEY MAP - 1:1250

ELEVATIONS - 1:100

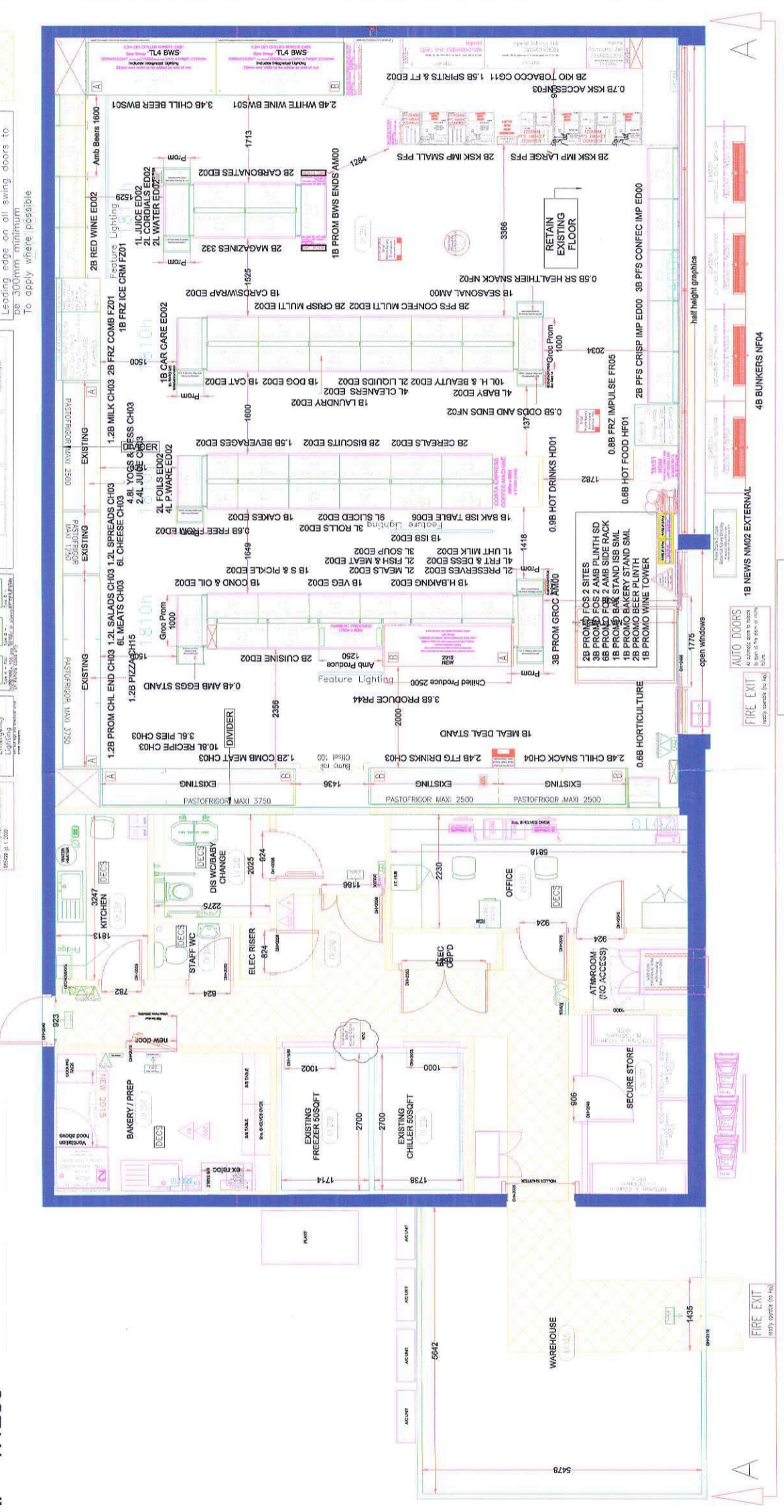

SHOP FLOOR - 1:50

CUSTOMER ENTRANCE

Equality Guidelines
 Minimum 850mm pinch point
 Minimum 1200mm turning circle
 Minimum 850mm gap behind the kiosk
 front edge to backline
 Leading edge on all swing doors to be 300mm minimum
 To apply where possible

Back of House Notice Boards to be positioned where needed

Key for Refrigeration Protection
 Key for Refrigeration Protection
 Fire Exit
 Fire Exit (ready service for fire)

The co-operative food

POUND HILL (PFS), CRAWLEY
 8 Pound Hill Parade
 Crawley
 RH10 7EA

Store Phone No: 01293 513310
 Format: PFS
 Hub Number: 9845

Drawing Information
 Brief Description: Of Works:
 Proposed Future Layout
 Latest system drawing
 Job Originated By:
 Refreshment Programme 2015 Moscow

Drawing No: F5
Macro Rev: M2
The Co-operative Group
 8 Pound Hill Parade, Crawley, West Sussex, BN11 1AB
15/10/2018

Description of Amendments	FEASIBILITY CAD	LOCKED CAD	SECOND REVIEW CAD	31.07.2015/Patrol Pounds Hill - P3F1M0/AJ	16.05.2015/Patrol Pounds Hill - P3F5M0/AJ	Standard Notes	CDM Regulations 2015	Exceptions	Additional Equipment	Drawing Information
<p>12.07.2015/Patrol Pounds Hill - P3F2M0/RFA(G) FIRST REVIEW CAD 1. Oven omitted. 2. New lockers. 3. Fixture locations amended. 4. Existing cabinets retained. 5. New cabinet. 6. New fixtures. 7. ISS relocated. 8. PFS added. 9. Fixtures amended. 10. Note amended.</p>	<p>22.08.2015/Patrol Pounds Hill - P3F5M1/RSW SECOND REVIEW CAD Case comments amended. 1. Case comments amended. 2. Case comments amended. 3. Logo station allocated. 4. Plinth added. 5. Fixture omitted. 6. Plinth added. 7. Community screen added. 8. Existing backline retained. 9. Plinth added. 10. Note amended.</p>	<p>04.08.2015/Patrol Pounds Hill - P3F4M0/AJ THIRD REVIEW CAD FSS plinth and flowers swapped RTC added Boxing out at till added</p>	<p>28.08.2015/Patrol Pounds Hill - P3F5M2/SFW HEALTHY SNACKING SR added opposite the kiosk.</p>	<p>16.05.2015/Patrol Pounds Hill - P3F5M0/AJ LOCKED CAD</p>	<p>16.05.2015/Patrol Pounds Hill - P3F5M0/AJ LOCKED CAD</p>	<p>VIA FIRE EXITS: Always refer to latest building specifications for fire exit door specifications for fire exit doors. For all fire exit doors, ensure that the door is self-closing and is not held open by a prop. For fire exit doors, ensure that the door is self-closing and is not held open by a prop. For fire exit doors, ensure that the door is self-closing and is not held open by a prop. For fire exit doors, ensure that the door is self-closing and is not held open by a prop.</p>	<p>CDM Regulations 2015 The following table provides a summary of the key requirements of the CDM Regulations 2015. It is intended to provide a high-level overview of the requirements and is not intended to be a substitute for the full Regulations. For more detailed information, please refer to the full Regulations.</p>	<p>Exceptions Any areas of this proposal that are not covered by the CDM Regulations 2015 are detailed below. The areas not covered by the CDM Regulations 2015 are detailed below. The areas not covered by the CDM Regulations 2015 are detailed below. The areas not covered by the CDM Regulations 2015 are detailed below.</p>	<p>Additional Equipment VND 2 3594 Sq. Ft. 1891 Sq. Ft. 1970 Sq. Ft. 1974 Sq. Ft.</p>	<p>Drawing Information Existing 2 3594 Sq. Ft. 1891 Sq. Ft. 1970 Sq. Ft. 1974 Sq. Ft.</p>